

PROJECT NAME : SANCTUM PALACIO

ADDRESS : PRE. NO.- **39/1 MADHYA PARA**, ASSESSEE NO - 31-112-11-0515-2, WARD NO - 112 UNDER KOLKATA MUNICIPAL CORPORATION, P.S. & P.O.- BANSDRONI, KOLKATA - 700070.

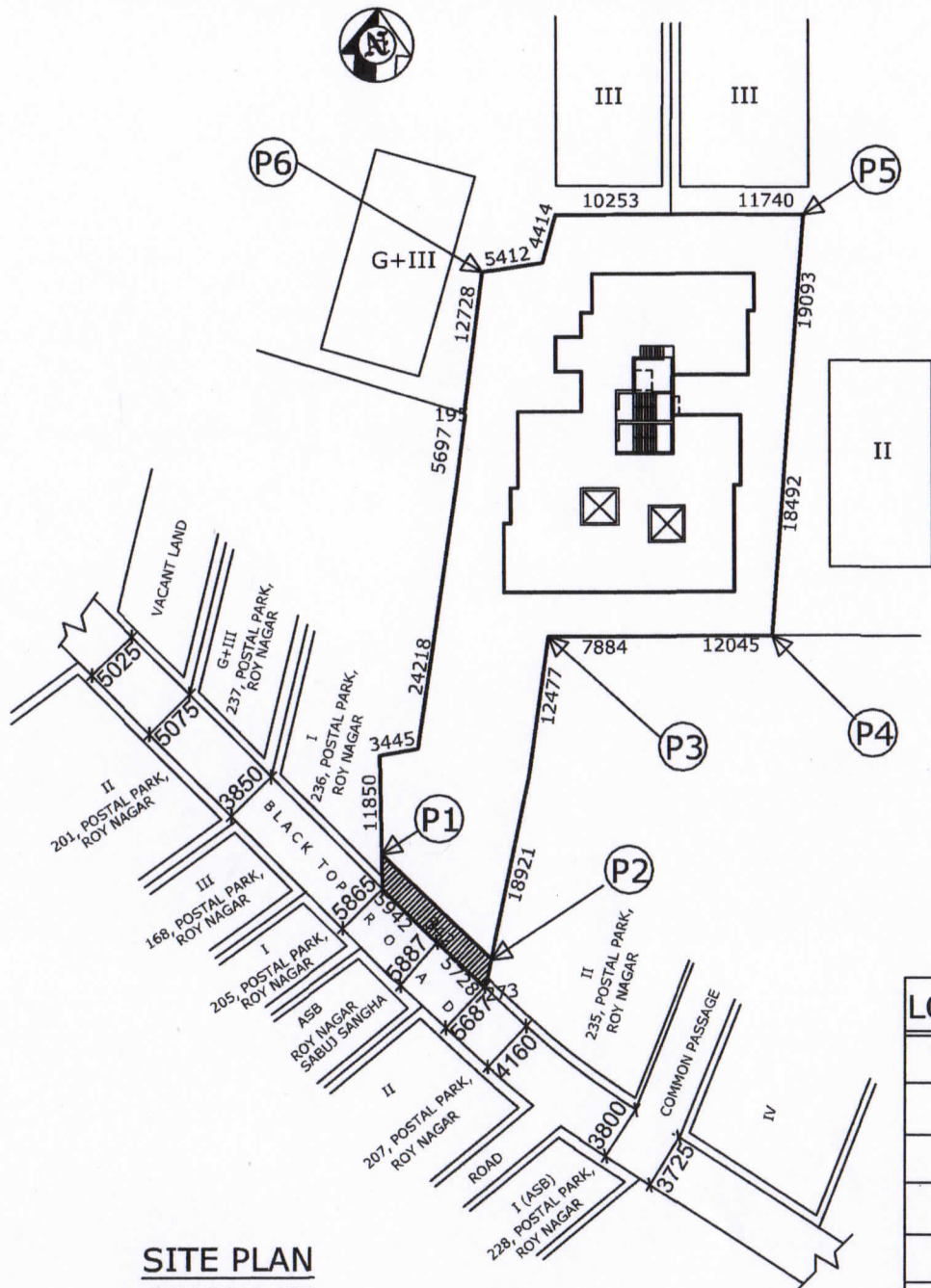

**SITE PLAN**  
SCALE 1:600

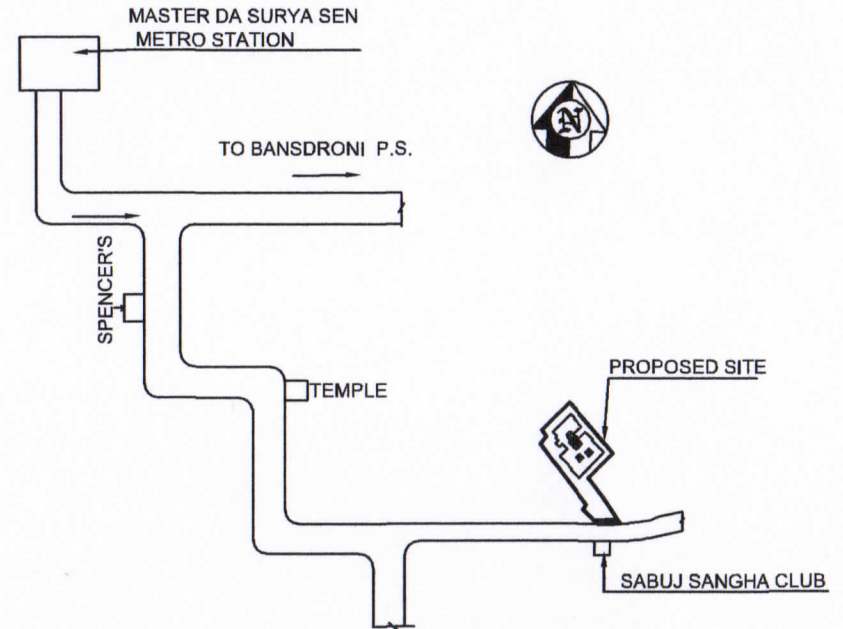

**KEY PLAN**  
SCALE-1:4000

| LOCATION | LATITUDE            | LONGITUDE           |
|----------|---------------------|---------------------|
| P1       | 22° - 46' - 89.654" | 88° - 36' - 07.442" |
| P2       | 22° - 46' - 90.133" | 88° - 36' - 07.713" |
| P3       | 22° - 46' - 90.494" | 88° - 36' - 10.338" |
| P4       | 22° - 46' - 90.348" | 88° - 36' - 11.559" |
| P5       | 22° - 46' - 93.340" | 88° - 36' - 12.642" |
| P6       | 22° - 46' - 93.672" | 88° - 36' - 10.325" |

**T. N. ASSOCIATE**  
*Narayan Chandra Mukherjee*  
Partner

\_\_\_\_\_  
SIGNATURE OF THE OWNER(S)